

Pioneer Houses

Made by Rosie Wood in 1987
For the LSU Shreveport Rural Life Museum

1. Single Pen House

Cut out the two parts of the house design. Cut tiny slit in side of door to insert railing. Steps will be inserted here later. Fold all the tabs toward the inside to make right angles. Then fold front and side to make the corner of the house. Glue tab "A" overlapping tab "a". Fold and glue back and side the same way as front and side. Tab "C" overlaps tab "c". Next, overlap and glue "D" to "d" and "B" to "b". Glue side tabs to sides of house.

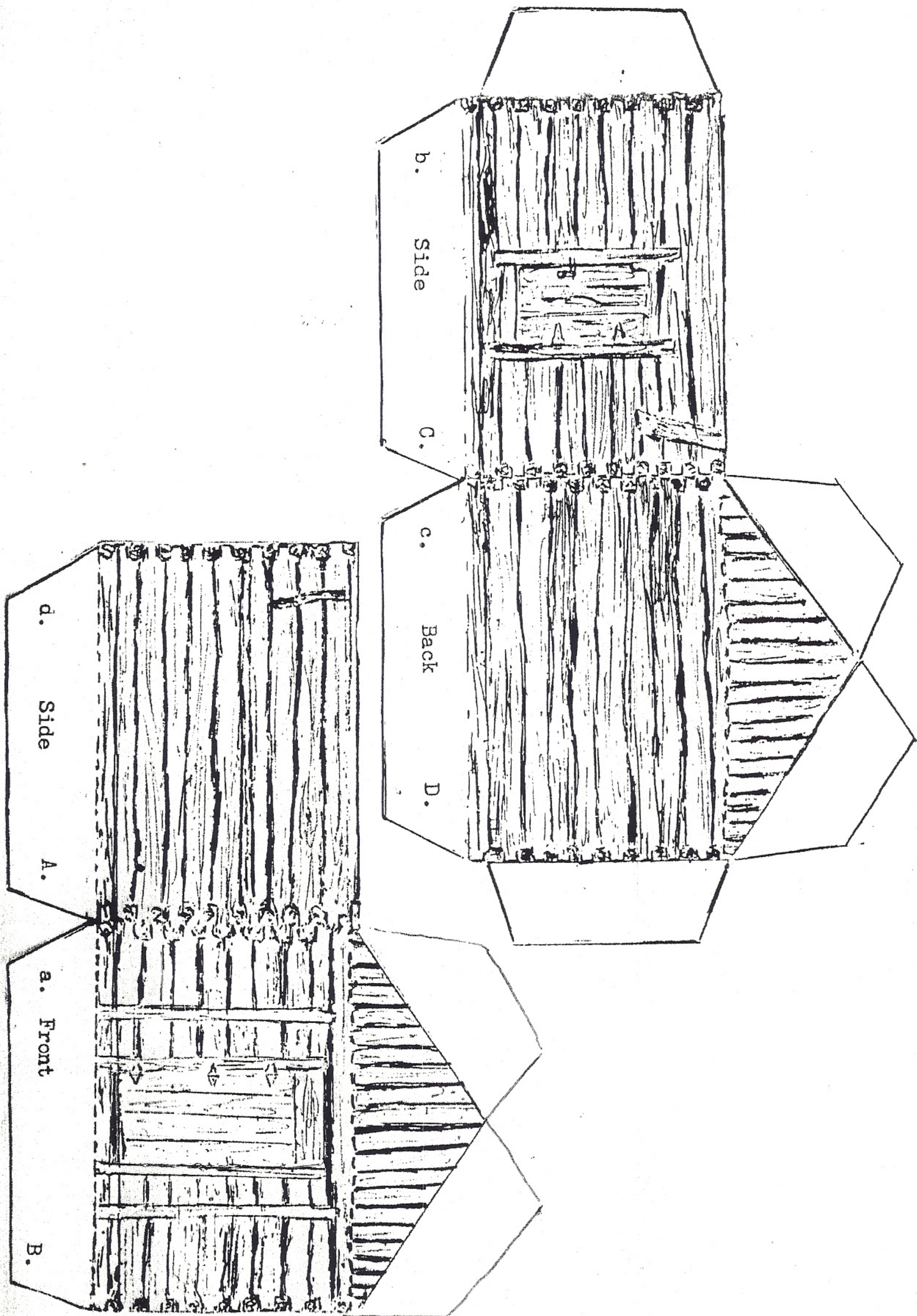

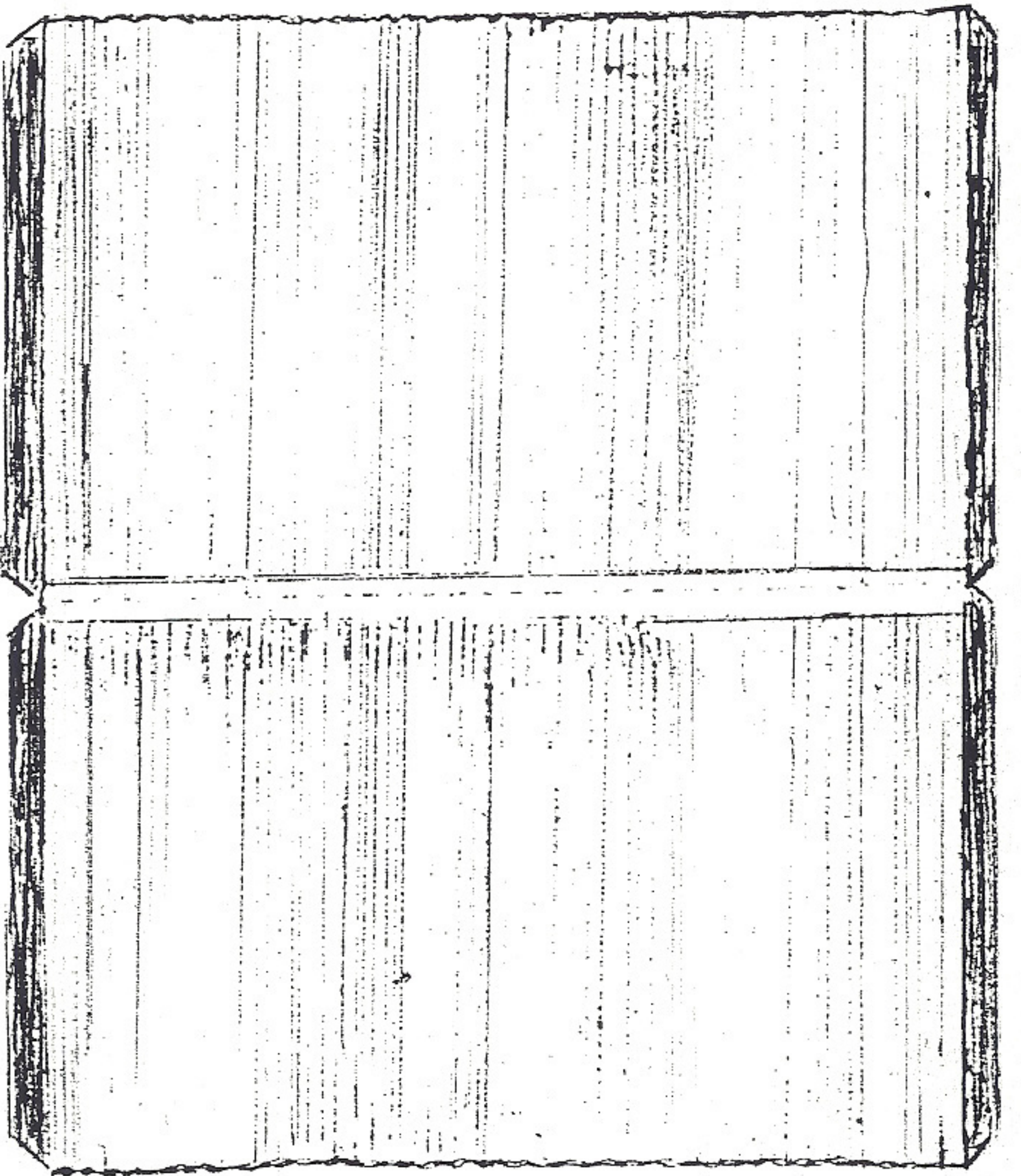

Cut out roof design. Fold black overhang down at right angles on the front and back. Fold roof lengthwise down the center. Place the roof on carefully to check **equal** distance extending front and back. Glue the back of the roof to the folded tabs on the back top of the house.

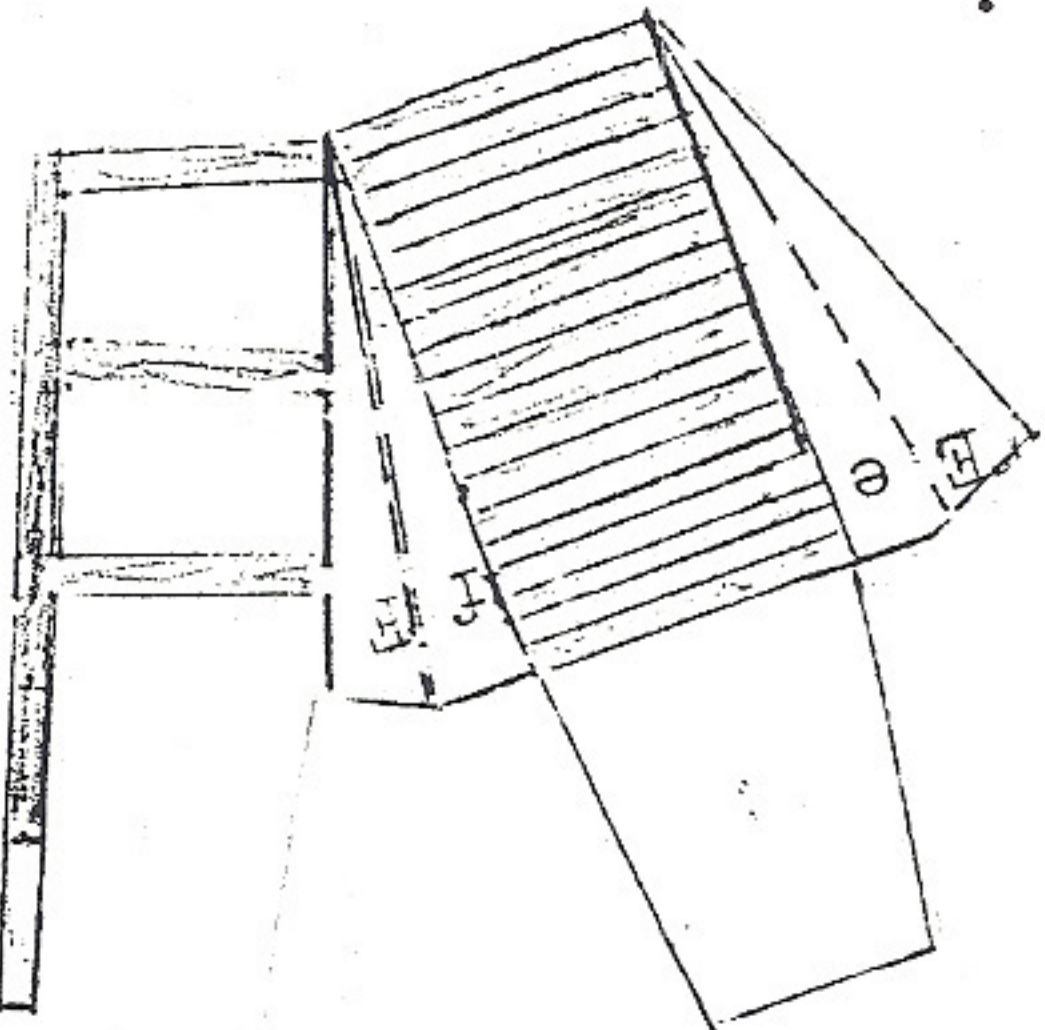

Fold the pointed designs so that "E" faces "e" and "F" faces "F". Glue to make angled walkway. Insert tab in slit under door in front. Insert top end of railing in slit at side of door. Fold tabs inside and glue.

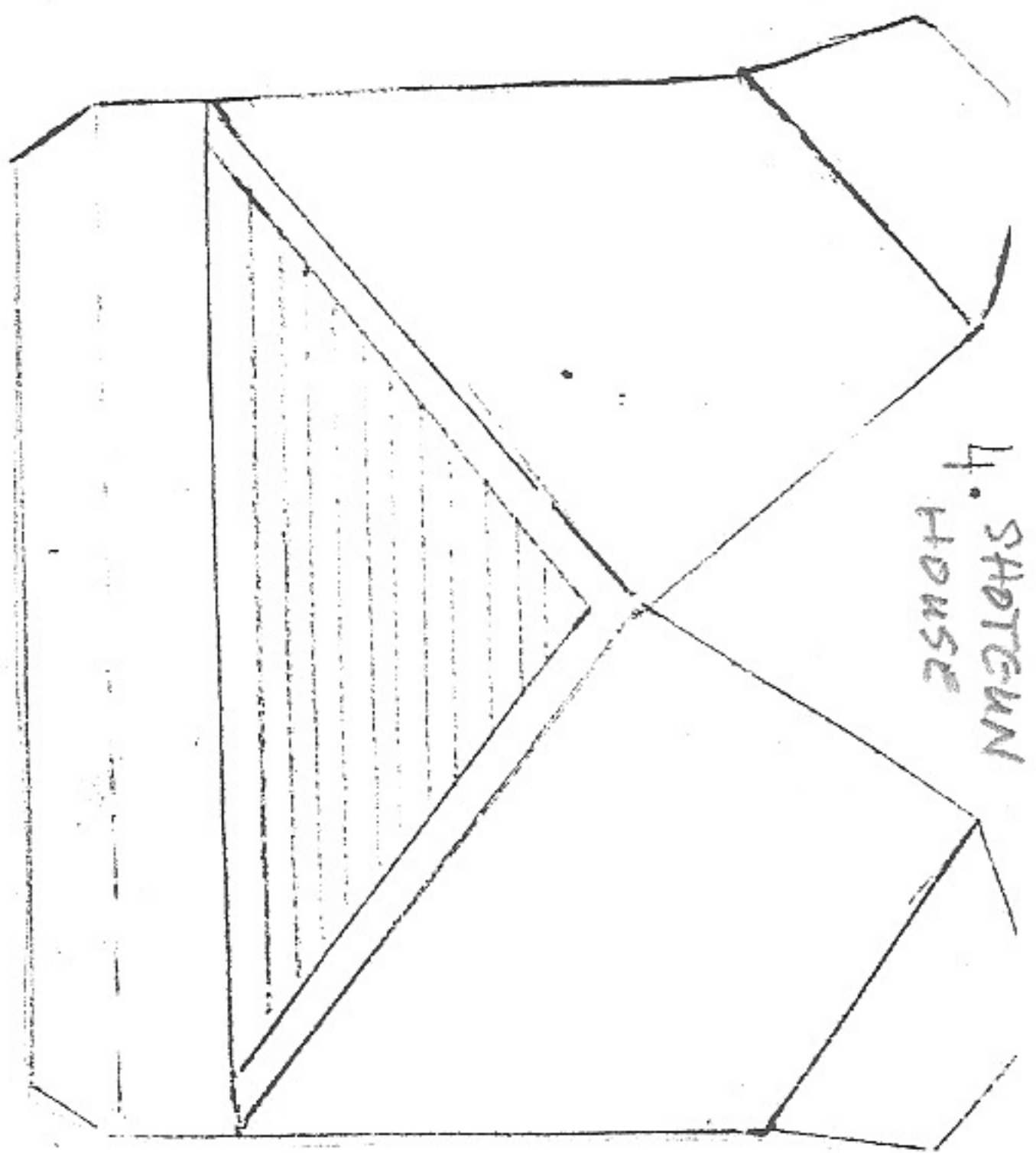

1. Cut out design of inset on top of porch that fits under the roof.
2. Fold the front small tab on dotted line up at a right angle.
3. Fold in front of the triangle design up at a right angle.
4. This will form a narrow rectangular base.
5. Fold each large section on back of triangle design back at right angles.
6. Fold tabs down at right angles.
7. Glue bottom of narrow rectangular base to place marked on top of porch.
8. Fold little tabs over the top of the house triangle and glue.

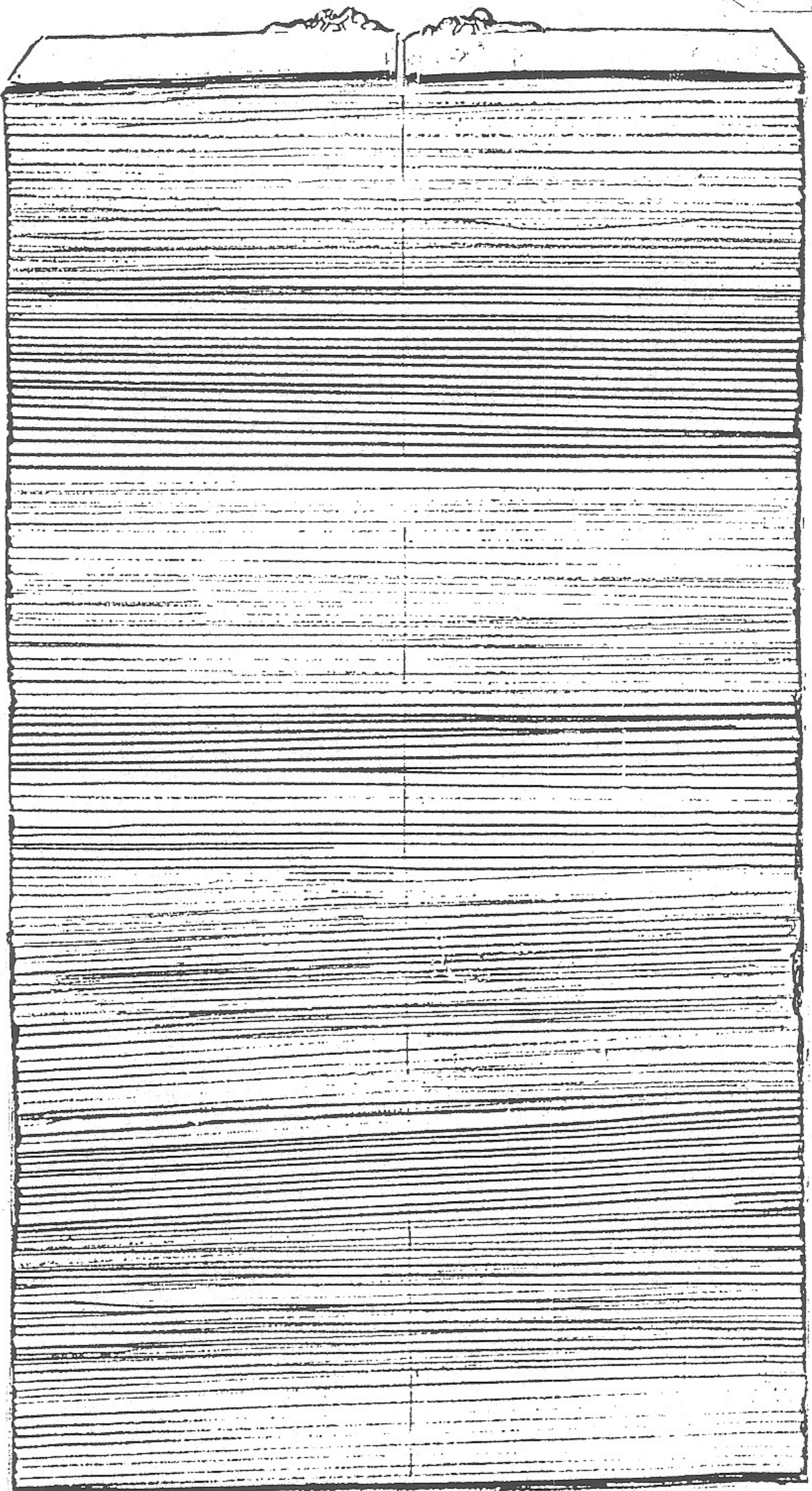

1. Cut out roof design.
2. Cut tiny slit in the middle of the design on the front edge of the roof overhang.
3. Fold roof lengthwise down the center of the tin design.
4. Fold the front edge of the roof overhang at right angles to the length.
5. The center slit will allow the sides to overlap in the center so that angle of the roof will fit on the top of the house and porch.
6. Place the roof on the house so that the back edge extends slightly less than $\frac{1}{4}$ ".
7. Glue the back of the roof to the folded tabs on the back top of the house.
8. Then glue the roof to the inset on the top of porch.

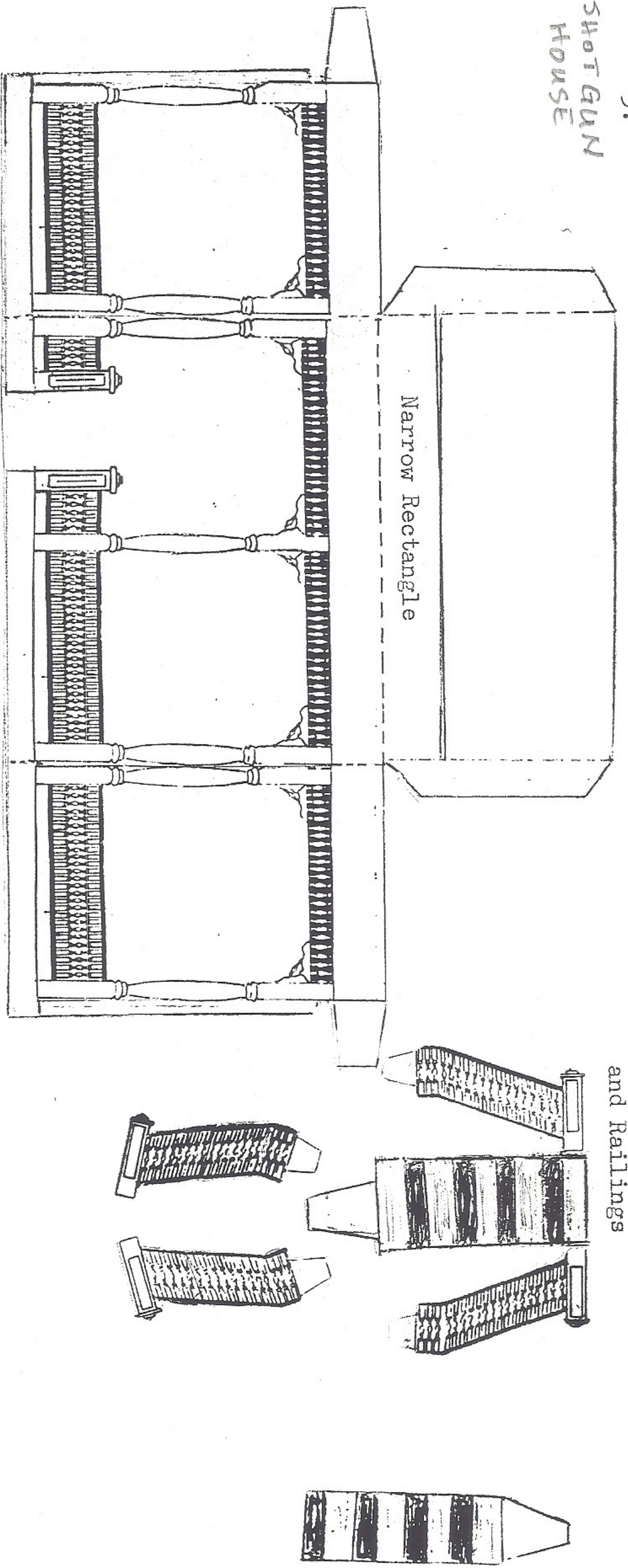

1. Cut out front porch design.
2. Fold tabs on sides of top of porch down at right angles.
3. Fold top of porch back to form a right angle with front of porch.
4. Fold between the two posts to make right angles going back toward the top of the porch.
5. Crease these angles to make sharp edges.
6. Unfold, lay flat and cut out the four areas between the posts and the opening between the banisters.
7. Cut tiny slits in the middle of the banisters. (You may omit the cuts in the banisters and glue the railing tabs folding them behind the banisters when steps are inserted later.)
8. Refold, glue the tabs on the sides of top of porch to the back of the top of the sides of porch.
9. Carefully glue the white edge at the bottom of the porch so that it covers the white edge on the base, leaving the bricks showing below.
10. Insert the tabs into the top edges of the front of the house.
11. Glue the tiny edges behind the tall side posts to each side of the house.

Back Steps

Cut out design. Accordion pleat. Insert tab under back door. Fold tab and glue.

Front Porch Steps and Railings

Cut out the design with steps and railings attached and the two other railings.
 Glue the two extra railings to the back of the first design.
 Accordion pleat the steps.
 Fold the railings up so that they form right angles with the bottom step.
 Insert tab on steps into the slit that was cut in the base between the banisters.
 Insert tabs of railings into banisters (or fold and glue behind banisters).

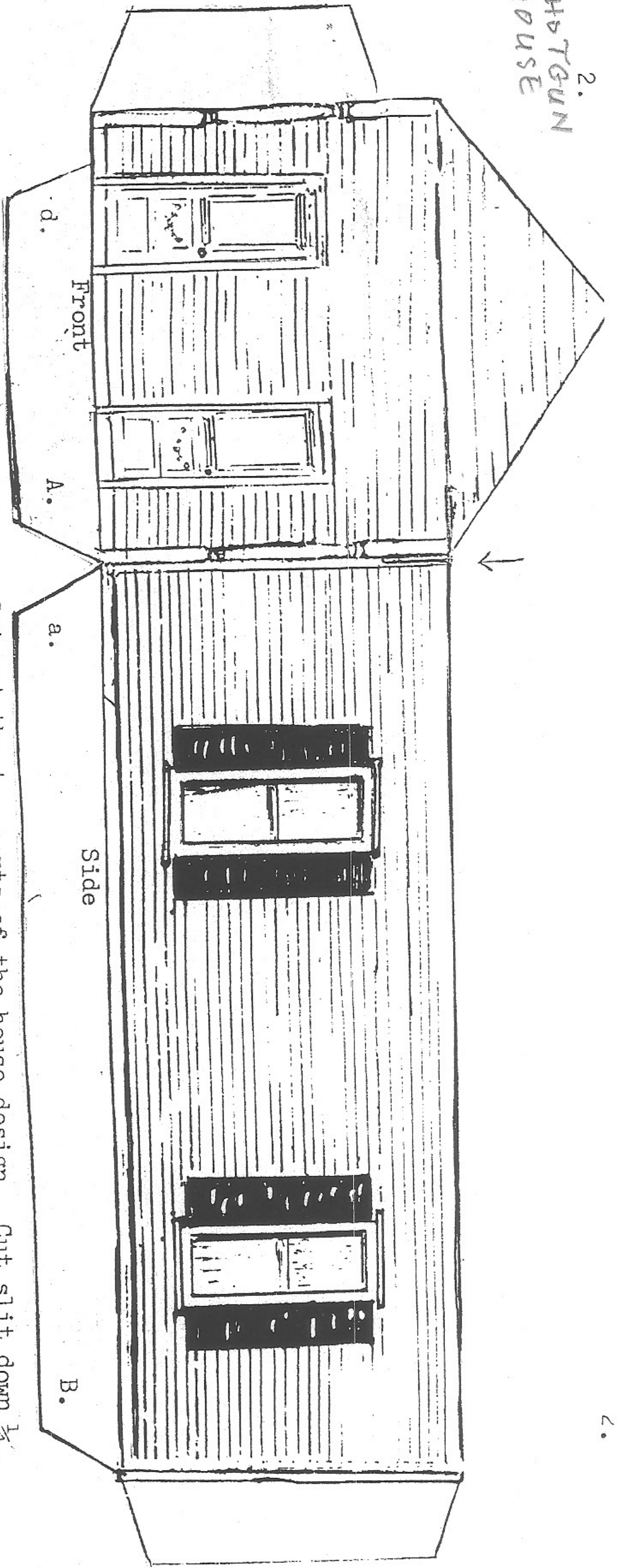

Cut out the two parts of the house design. Cut slit down $\frac{1}{4}$ between front and side of house. Then cut another slit on black line under door in back. Steps will be inserted here later. Fold all the tabs toward the inside to make right angles. Then fold front and side to make the corner of the house. Glue tab "A" overlapping tab "a". Fold and glue back and side the same way as front and side. Tab "C" overlaps tab "c". Next over lap and glue "D" to "d" and "B" to "b". Glue side tabs inside. Glue the bottom of the house to the top of the base on the white rectangle. The front porch design will be attached next over the smaller rectangle.

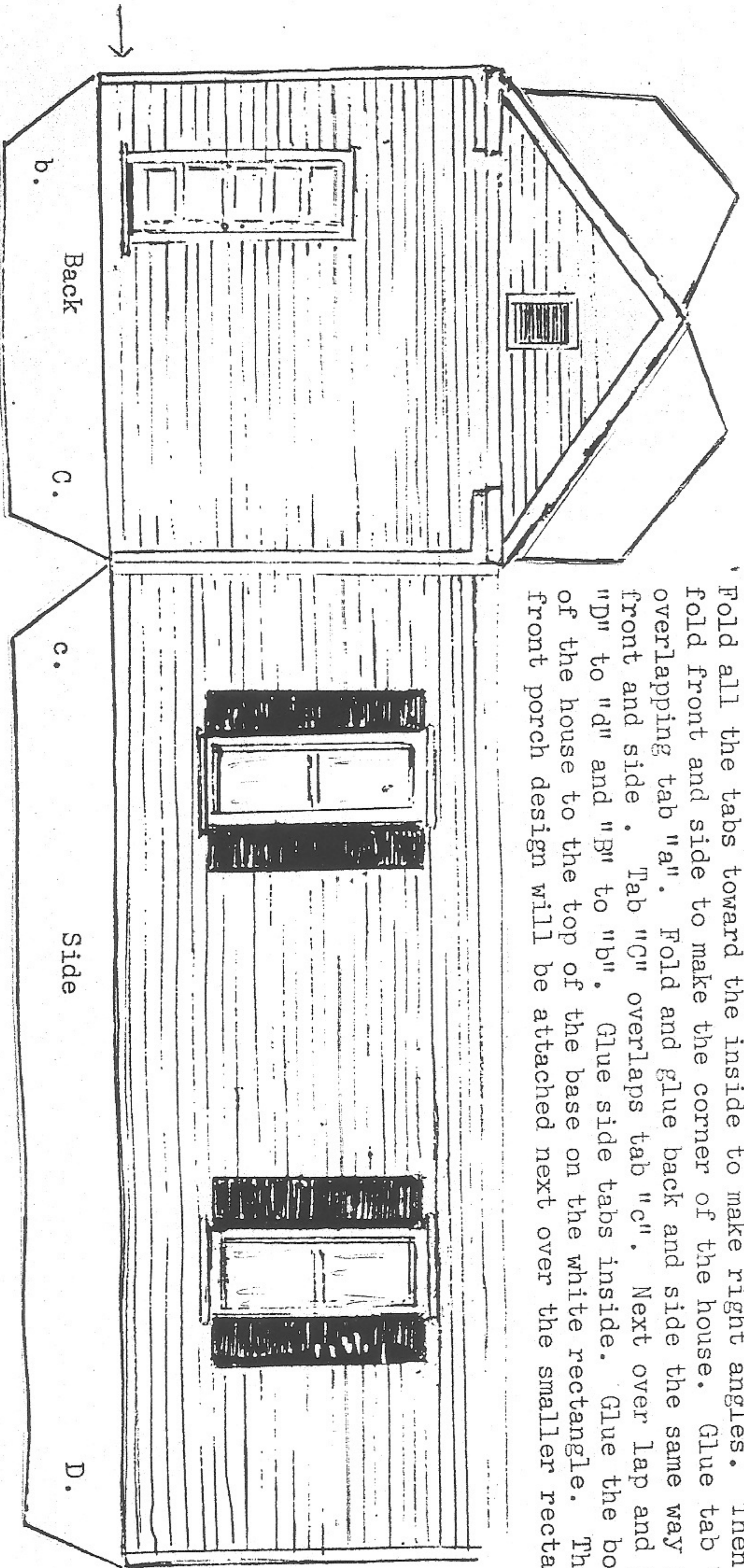

Shotgun House

Cut out around design below for base of the shotgun house. Cut four slits, one at each corner tab, shown by the double line. Cut one $\frac{1}{2}$ " slit on front of porch that is also shown by a double line. Fold edges down on dotted lines. Fold corner tabs at right angles and glue under the brick design to make base.

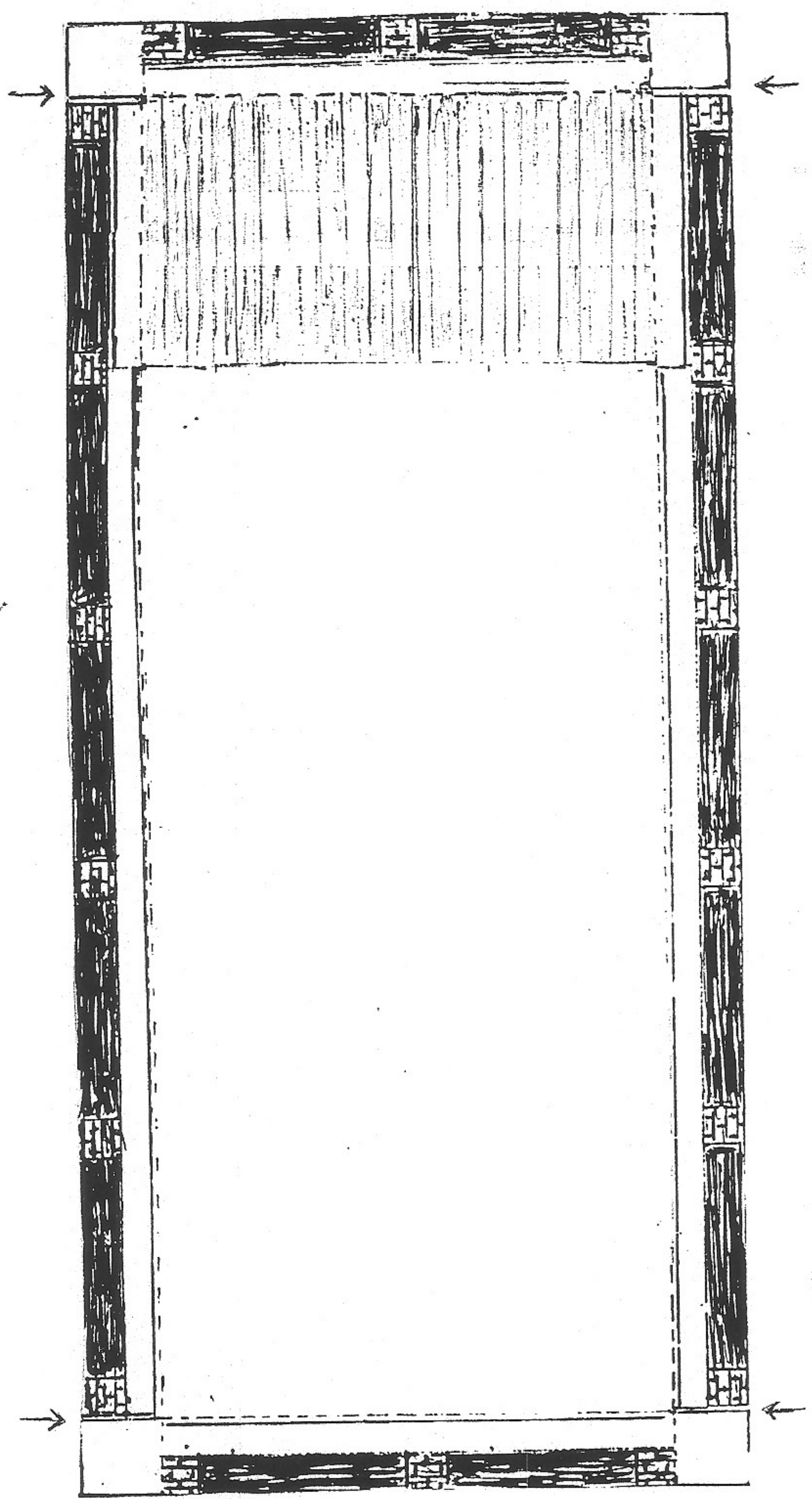

Roof

Fold roof in middle. Glue center shingles together. Fold again so that one side of the center shingles follows the angle of the same side. Attach to tabs at the top of square and rectangular structures. The tabs should be folded and glued to back of the roof design. Fit little cut-out area behind the chimney.

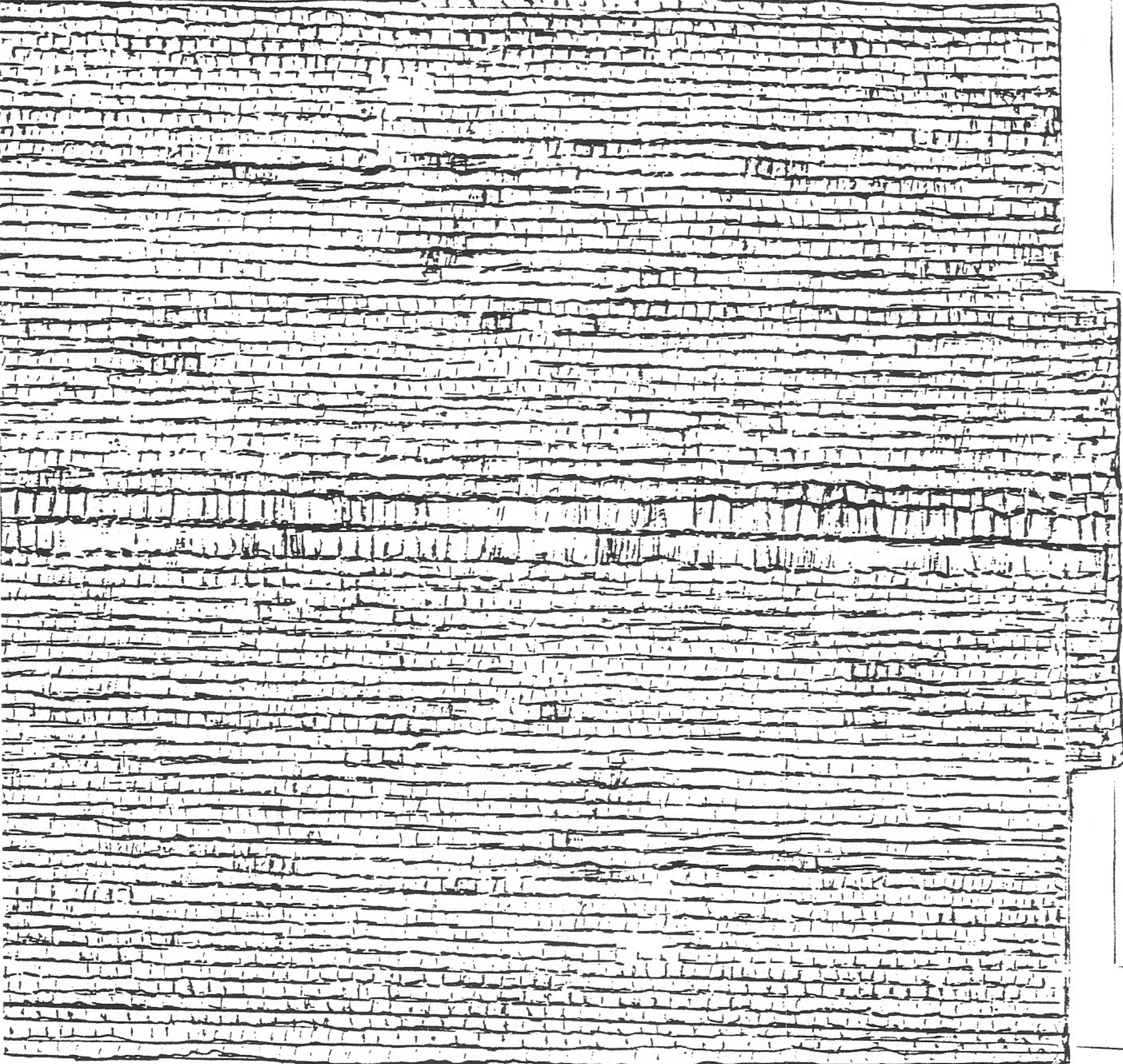

Dog-trot House 4

Posts and Rafters

There are three corner posts and rafters to be attached. Fold each of these on the long middle line. Cut on the solid lines to make small tabs. Arrows show where to cut at the tops, bottoms center.

Bend the folded rectangle so that the cut for a right angle with the middle fold. Secure a glue. The effect of a two sided post and rafters created. Fold the bottom tabs to make a base for post. Glue it to the number it matches. the rafter tabs together and then glue to the structure near the top of the door.

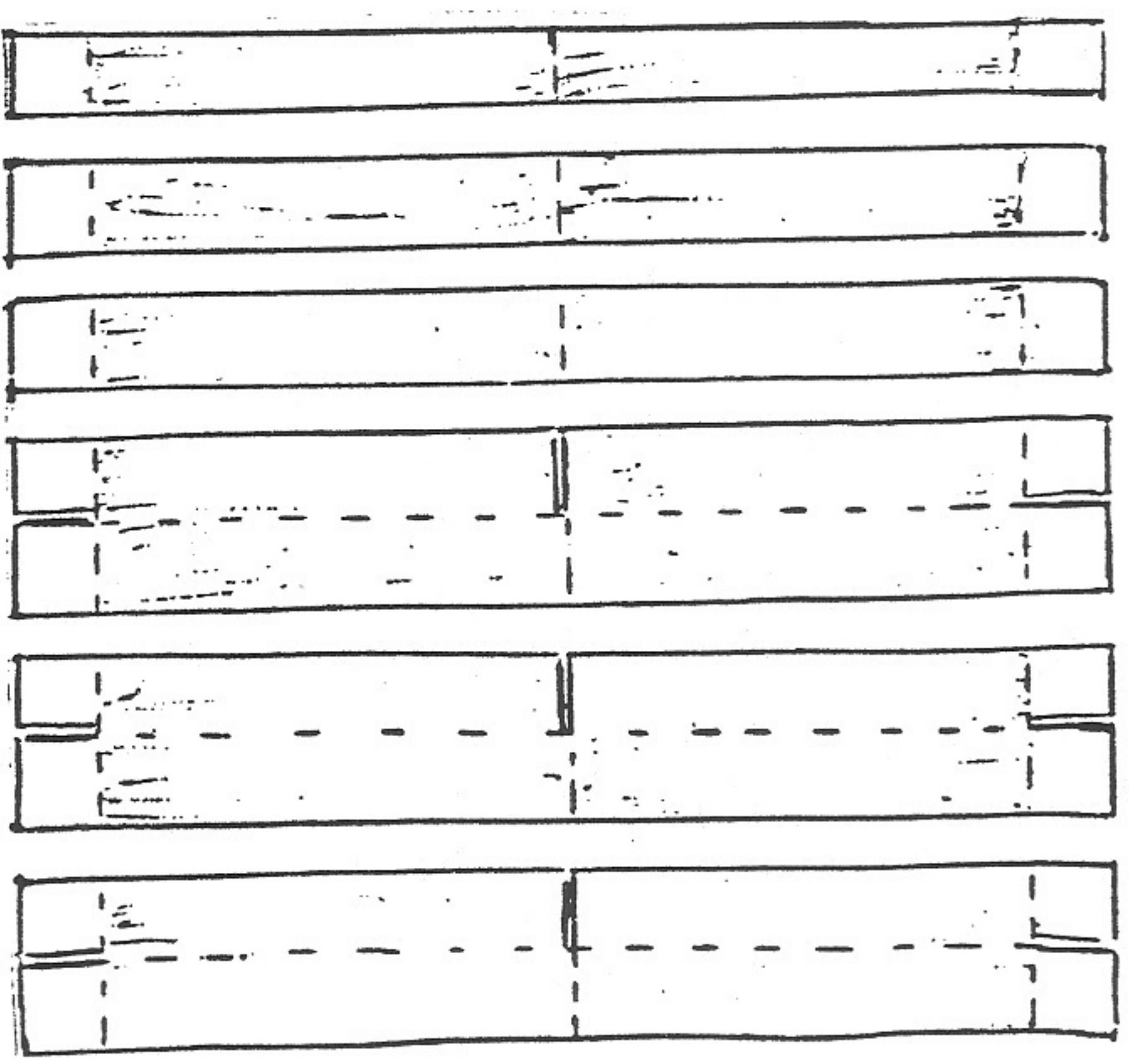

Dog-trot House

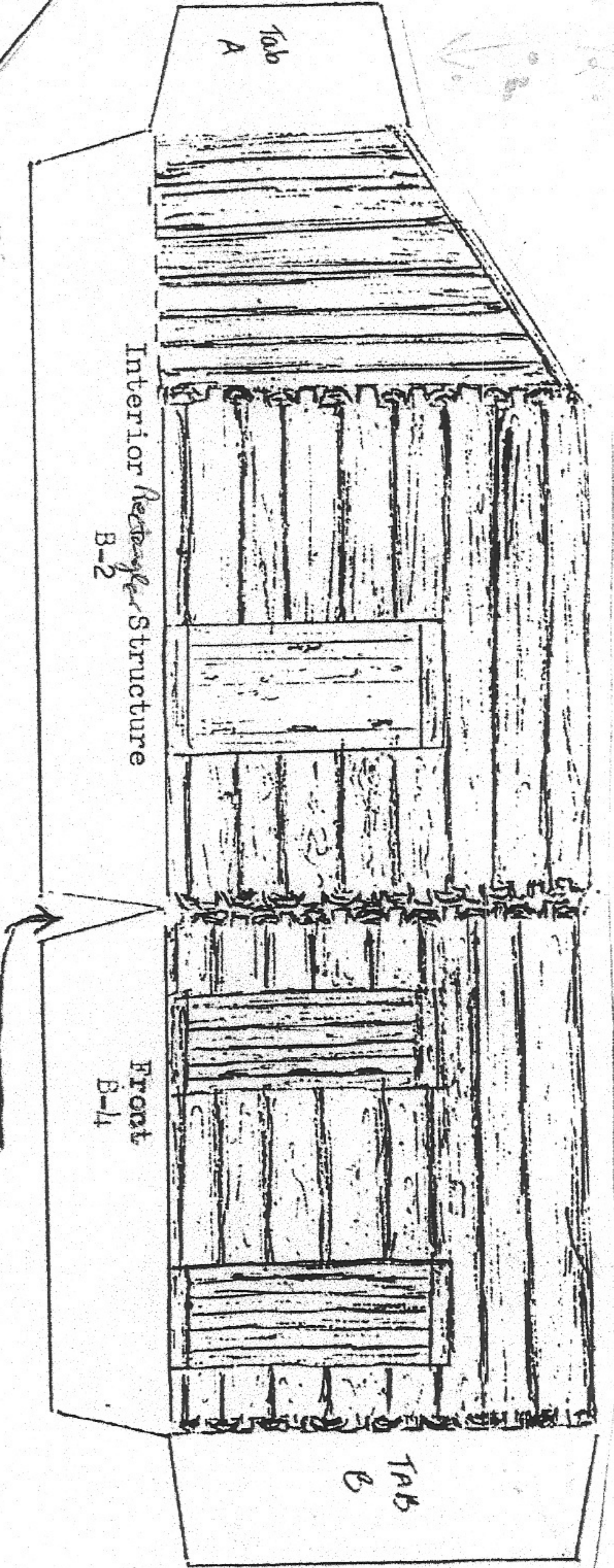

Fold to make right angle.

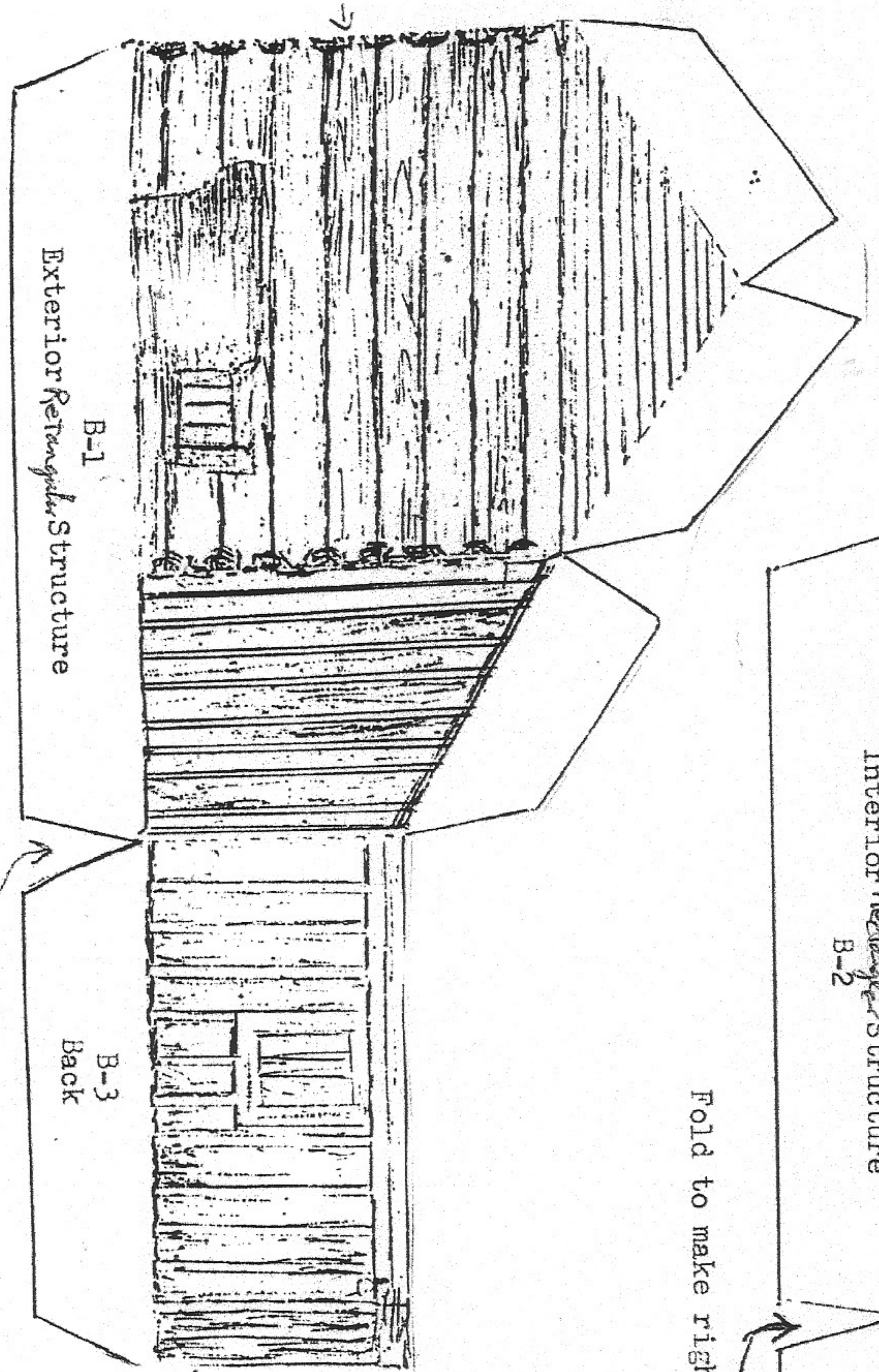

Fold to make a right angle.

Fold
 bottom tabs in at right angles.
 Fold side tabs in at right angles.
 Fold at right angle at "v" of
 bottom tabs. Glue short side tab
 to inside of short design-B-3.
 Glue tall side tab to inside of
 tall design-B-1.

Glue bottom tabs together at corners.
 Glue to base matching numbers.
 B-1 to B-1

Side A

2.1
Deerfoot
House

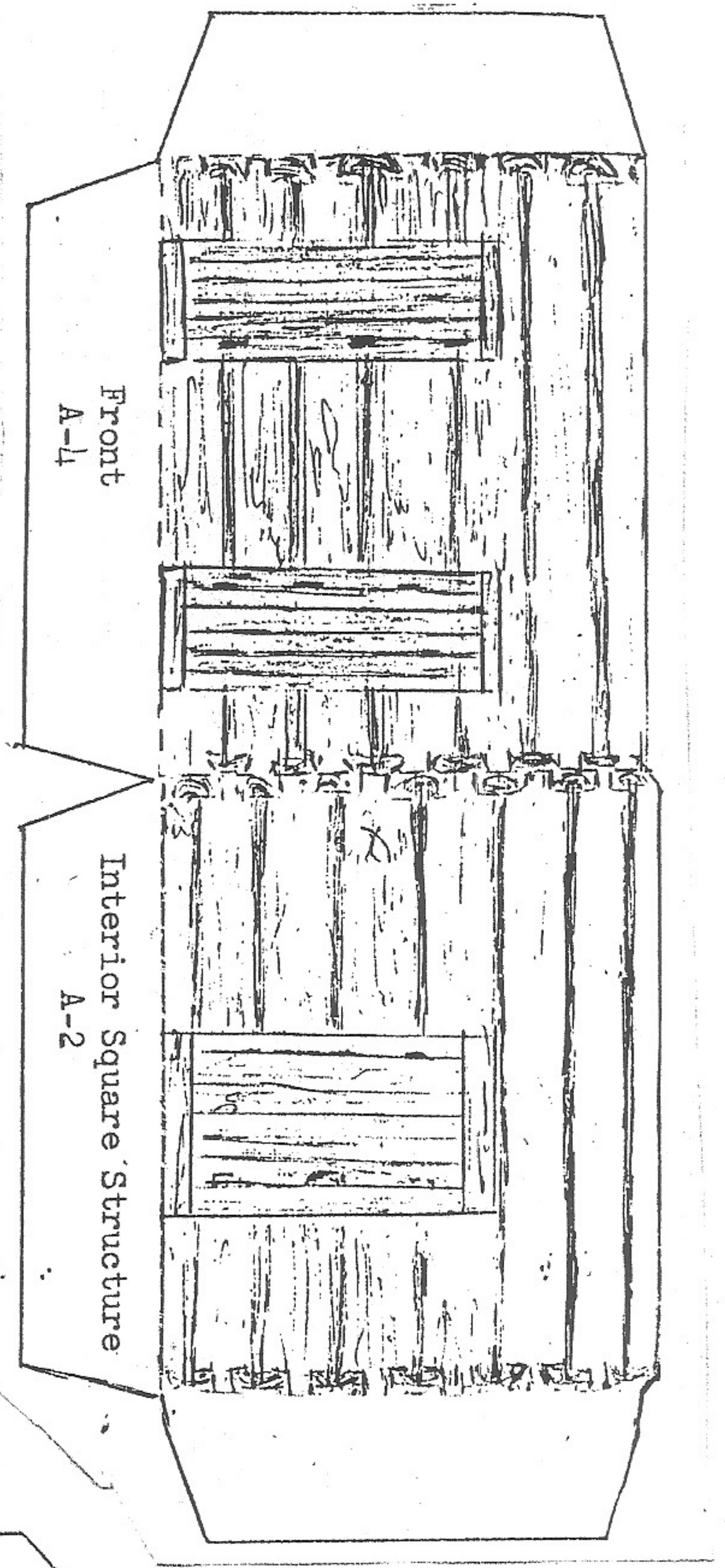

To make the square structure fold bottom tabs in at right angles. Fold side tabs in at right angles. Fold at right angle at "v" of bottom tabs. Place the folded exterior and back sides so that the fireplace extends over the area marked fireplace. Glue the side tab on the Front-A-1 behind the design of Exterior Square Structure A-1. Glue the other side tab to the inside of the back design.

Glue bottom tabs together at corners
Glue to base matching numbers.
A-1 to A-1

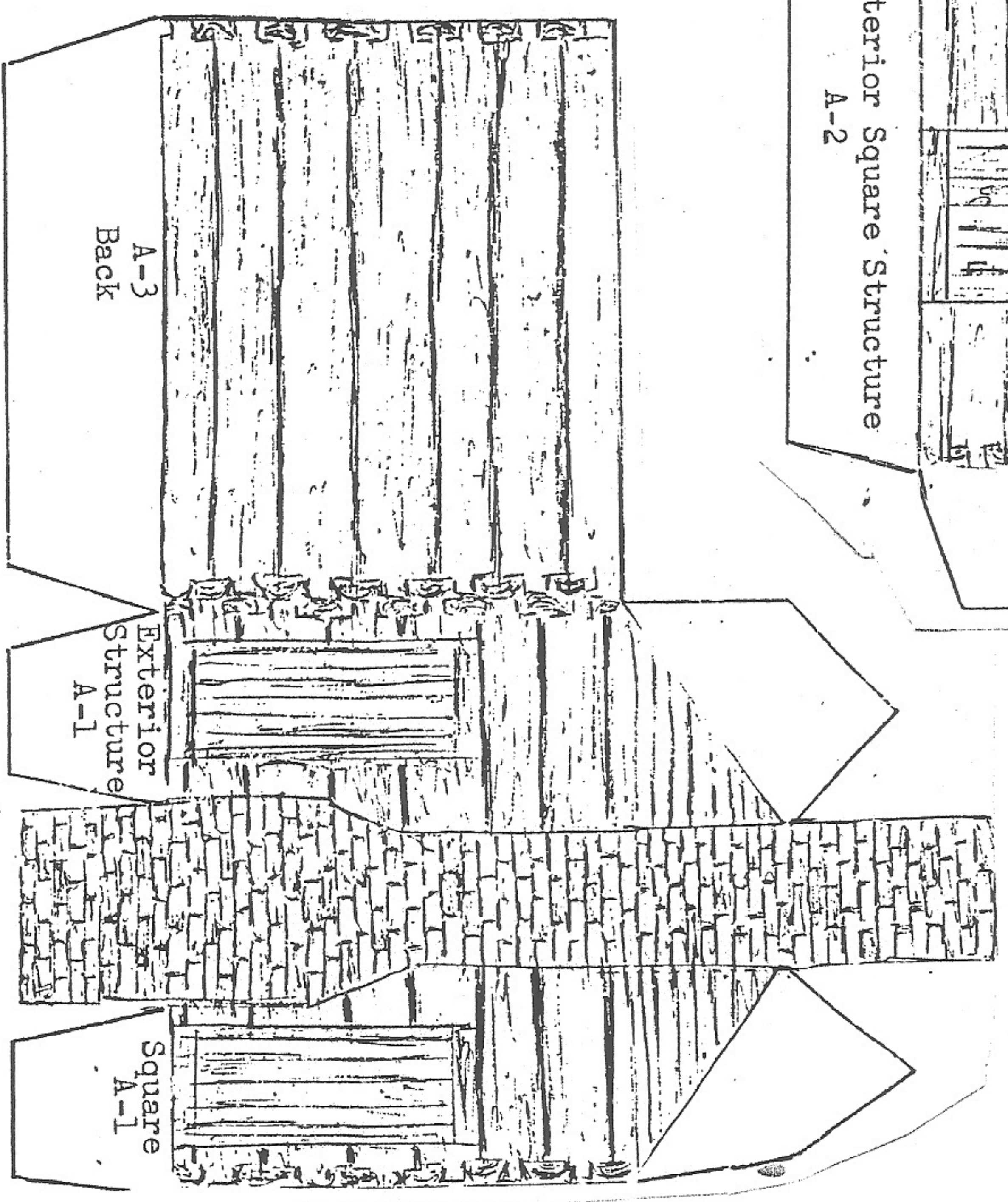

Square Structure

Base for Dog-Trot House

Cut base out carefully. Fold sides of the base on the dotted lines. Cut the corners on the solid black line making a tab to fold and glue behind the design. Be sure to cut the slits for the front and back steps first.

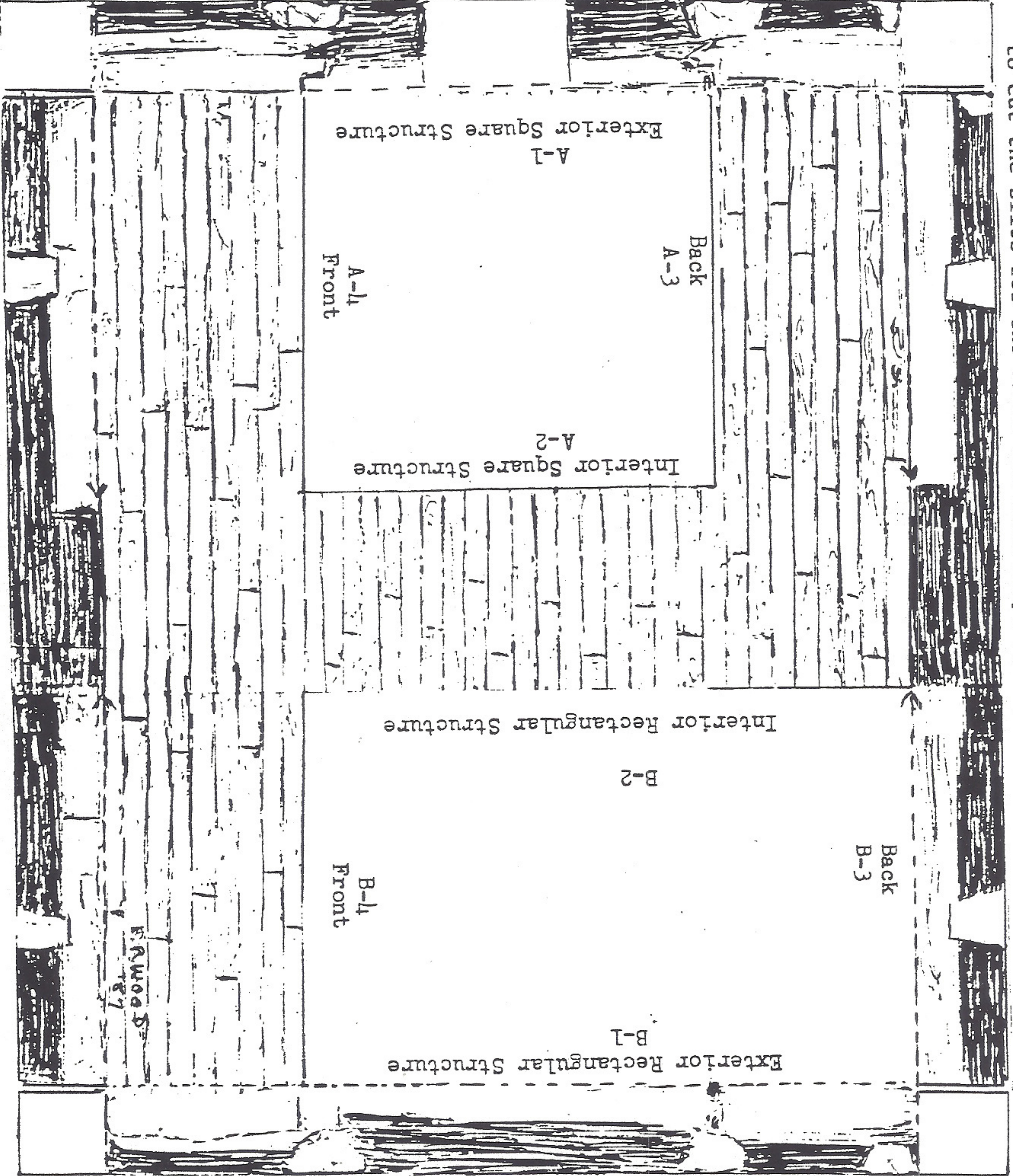

Cut slit on base between arrows to insert tab of folded steps. Glue tab to back of base.

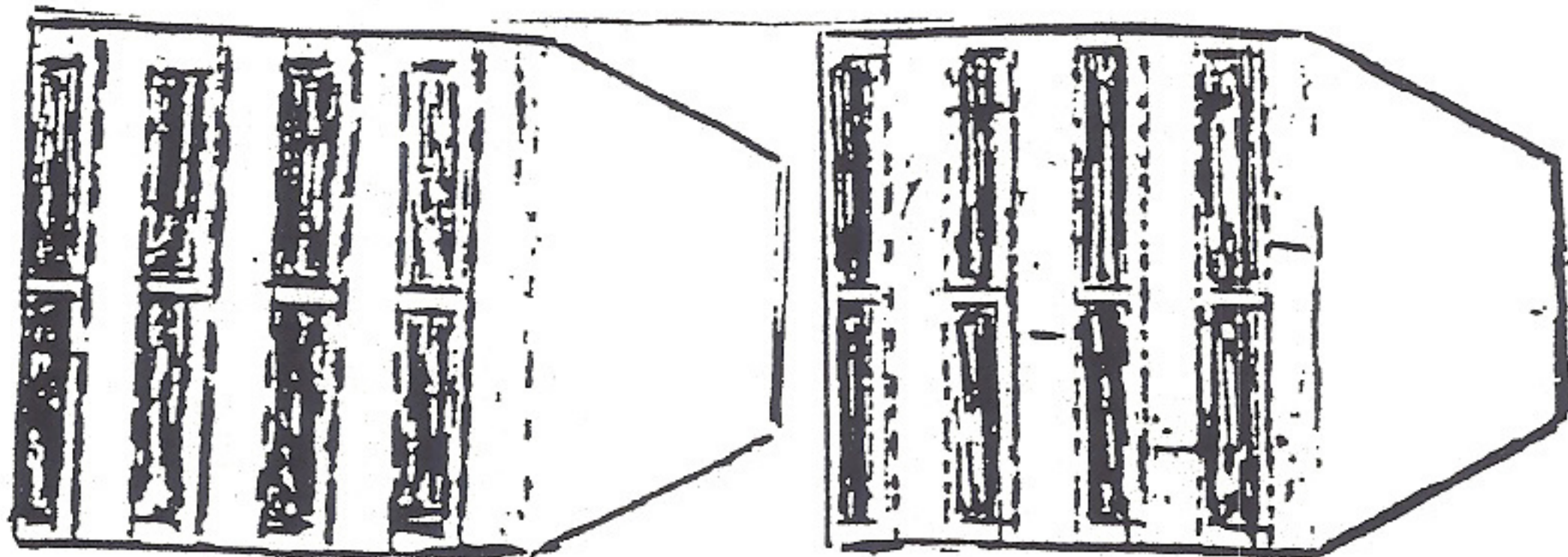

Fold the steps...the first dotted line out, next in. This makes pleats that look like an accordion.